

REPAIR PARTS - MODEL 416-511

1	10525-5	FRAME WELDMENT, RED	67	10929	DECAL FLOOR PAN CRITTER II DLX
ASM	10869	TIE ROD ASM LONG (INCL. 2, 4-7)	68	8381	DECAL MADE IN AMERICA
ASM	5020	TIE ROD ASM SHORT (INCL. 3-7)	69	1049	DECAL CAUTION DRIVE COVER
2	10868	TIE ROD 19.0	70	8154	DECAL NO CHILD UNDER 12 YRS
3	5004	TIE ROD 7.25	71	4912	DECAL WARNING CHAINGUARD
4	1415	TIE ROD END LH THREAD	72	8138	DECAL WARNING ENTANGLEMENT
5	1414	TIE ROD END RH THREAD	73	6791	DECAL OIL CLUTCH HERE
6	9024	NUT, 3/8-24 JAM LH THREAD	74	9579	DECAL NO RIDERS ALLOWED
7	9092	NUT, 3/8-24 JAM RH THREAD	75	9373	DECAL TIRE PRESS 3.6/3.6
8	9674	SPACER, 3/8 ID X 3/8 LONG	76	5027	MANCO SERIAL NUMBER
9	9146	BOLT, 3/8-16 X 1.50	77	8373	SEAT BELT - SHOULDER/LAP
10	9158	BOLT, 3/8-16 X 2.25	78	8399	DECAL WARNING SEAT BELT
11	9006	BOLT, 1/4-20 X .50 HEX FLANGED WHIZ	79	9188	BOLT, 1/2-13 X 1.50
NI	10548	SPINDLE WELDMENT LEFT BLACK	80	9022	WASHER, 1/2 FLAT
12	10549	SPINDLE WELDMENT RIGHT BLACK	81	2386	BOLT, 3/8-16 X 3.50
13	9709	COMPRESSION SPRING	NI	8746M	VIDEO TAPE SAFETY MANCO
14	5682	BOLT, 1/2-13 X 5.500	82	5287	BOLT #10-16 X .375 SELF TAPPING
15	1012	NUT, 1/2-13 TOPLOCK	83	5288	WIRE CLAMP
16	1046	NUT, 5/8-11 TOPLOCK	84	1189	NUT, 5/16-18 HEX TOPLOCK
17	1104	SPACER SPLIT .8120D .625ID 1.000L	85	9189	BOLT, 1/4-20 X .875 HEX FLANGED WHIZ
18	9309FP	WHEEL ASSEMBLY, IDLE (INCL. 19-22)	86	1876	BOLT 1/4-20 X .625 HEX FLANGED WHIZ
ASM	10769	WHEEL ASSEMBLY, DRIVE (INCL. 20-21, 23-31)	87	9968-2	SEAT FRAME WELDMENT BLACK
19	4915	TIRE 145/70 X 6" KNOBBY	88	6734	SEAT SLIDE FR - SHORT
20	3802	INNER TUBE 6"	89	8445	FLAG SAFETY W/ BRKT 3FT
21	5090	BEARING, 5/8" I.D.	90	10131	ENGINE 6HP TEC OHV W/LIGHTING COIL
22	5950	SPANNER, 5/8" I.D. X 2-1/8"	ASM	4335	CLUTCH .75ID 35 X 12 TEETH (INCL. 91-94)
23	8499B	TIRE & DRIVE WHEEL ASSEMBLY 145/70 X 6"	91	3141	RETAINING RING
24	9986	SPROCKET 35P X 80 TEETH	92	4491	DRUM/SPROCKET/BUSHING ASSEMBLY
25	1246	BRAKE DRUM, 4"	93	3146	FIBER WASHER
26	8598	SPANNER, 5/8 I.D. X 3.641	94	4496	CLUTCH ROTOR (WEIGHT ASSEMBLY)
27	8409	NUT, 1/2-20 HEX	95	1398	WASHER, 21/64 ID X 1 1/4 X 1/8
28	9169	NUT, 1/2-20 HEX JAM	96	1124	WASHER; 5/16 SPLIT LOCK
29	9190	BOLT, 3/8-16 X 3-1/4	97	1491	BOLT, 5/16-24 X .750
30	9091	WASHER, FLAT 3/8 SAE N	98	5964	DECAL, SHIPPED W/O OIL
31	9085	NUT, 3/8-16 TOPLOCK HEX	99	9677	DECAL, WARNING HDT SURFACES
32	1119	SPACER .625ID 1.0620D .125THK Z	100	9678	DECAL, ENGINE EXHAUST
33	2024	SPACER .875OD .625ID 1.500L Z	101	9101	BOLT, 5/16-24 X .500 W/ NYLOK
34	6309	PEDAL, THROTTLE TRIMMED	102	9186	BOLT, 5/16-18 X 1.500
35	9503	SPRING, PEDAL RIGHT WOUND	103	9030	WASHER, 5/16 INT/EXT LOCK
36	9929	RUBBER CAP .25ID X .25 BLACK	104	9060	WASHER, 5/16 FLAT
37	8252	THROTTLE CABLE 61 INCH	105	8227	NUT, 1/4-20 TINNERMAN
38	2748	CABLE STOP NUT	106	10749-2	PLATE, COVER 415 BLACK
39	2666	SWIVEL SCREW	107	10537	OVERHEAD BAR WELDMENT BLACK
40	6293	PEDAL, BRAKE TRIMMED	108	10544	CENTER BAR WELDMENT BLACK
41	9502	SPRING, PEDAL LEFT WOUND	109	10541	REAR BAR WELDMENT BLACK
42	1848	BOLT, 1/4-20 X 1.25	110	6540	DECAL, WARNING WEAR A HELMET
43	6349	BUSHING, 5/16 OD X 22G	111	8366R	FOAM, 12.5 RED
44	1389	BUSHING, 1/4 ID X .313	112	8367R	FOAM, 15.5 RED
45	1447	BOLT, 3/8 X 1-1/8 SHOULDER	113	9759R	FOAM, 30.0 RED
46	9091	WASHER, FLAT 3/8 SAE N	114	9758R	FOAM, 43.0 RED
47	9945-2	BRAKE ROD - FRONT BLACK	115	10493	PLASTIC HOSE CLAMP 1"
48	9946-2	BRAKE ROD - REAR BLACK	116	1269	MASTERLINK 35 CHAIN
49	1036	BRAKE BAND W/RETAINER	NI	1019	CABLE TIE
50	9118	PIN, CLEVIS 1/4 X 1.250 Z	NI	4350	OPERATOR'S MANUAL
51	9116	PIN, COTTER 3/32 X .750 Z			
52	6038	STEERING WHEEL			
53	9799	STOP SWITCH WIRE ASM			
NI	1406	STOP SWITCH WIRE EXTENSION			
54	9080	BOLT, 1/4-20 X 2.750			
55	9160	BOLT, 1/4-20 X .875			
56	9796	BOLT, #12-24 X .500 SELF TAPPING			
57	8369	HEADREST PLAIN			
58	8370	SEAT BACK/BOTTOM			
59	1263	NUT 5/16-18 HEX FLANGED WHIZ			
60	9978	CHAIN, 35 X 86P INCL. MASTER LINK			
61	10750	COVER, 415 W/W/O SR			
62	1982	PEDAL LATCH, BLACK			
63	1846	BOLT, 1/4-20 X .750			
64	9057	NUT, 1/4-20 TOPLOCK			
65	1854	WASHER, #14 FLAT MS Z			
66	4372	HANDHOLD STRAP			

ASM = ASSEMBLY
NI = NOT ILLUSTRATED

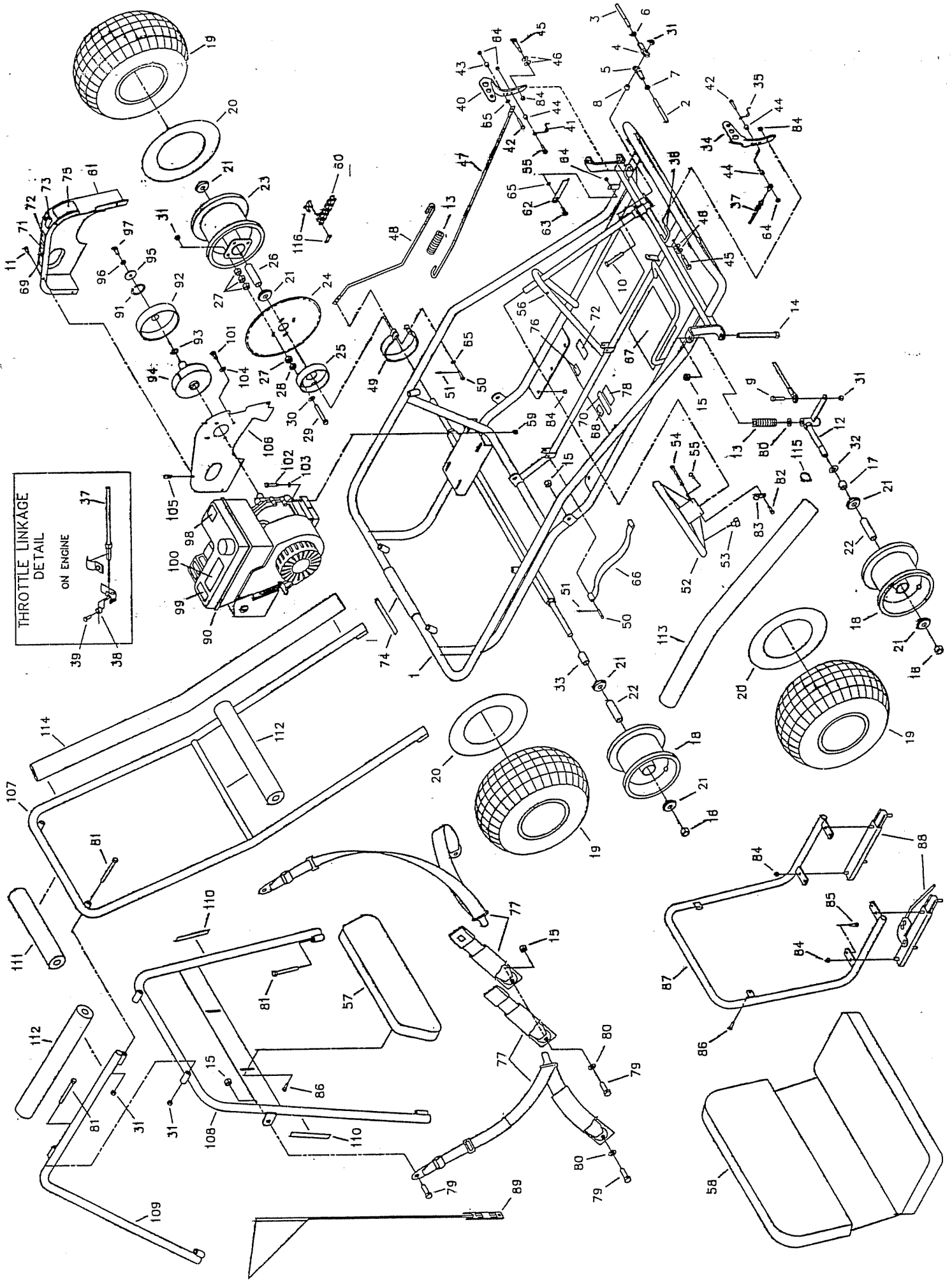

THROTTLE LINKAGE
DETAIL
ON ENGINE

