

Operator's Manual
SUPPLEMENT

Model Nos.
415B, 415D
416B, 416D, 416K

⚠ WARNING:

Read Engine
Owner's Manual,
Vehicle Operator's
Manual, and
Supplement
Carefully Before
Operating Vehicle.

Parts List



4404 Engle Ridge Drive, Fort Wayne, IN
ph (219) 432-1596 fx (219) 432-7870

**THIS VEHICLE IS FOR
OFF-ROAD USE ONLY**

BEFORE OPERATING THIS VEHICLE, THE OWNER AND/OR OPERATOR MUST UNDERSTAND THE VEHICLE WAS NOT DESIGNED OR MANUFACTURED TO MEET SPECIFICATIONS FOR USE ON STREETS, HIGHWAYS, OR THOROUGHFARES AND HAVE READ AND HAVE AN UNDERSTANDING OF ALL THE INSTRUCTIONS FOR SAFE ASSEMBLY AND OPERATION AS WELL AS THE INSTRUCTIONS GOVERNING THE ENGINE AND OTHER PORTIONS OF THE VEHICLE.

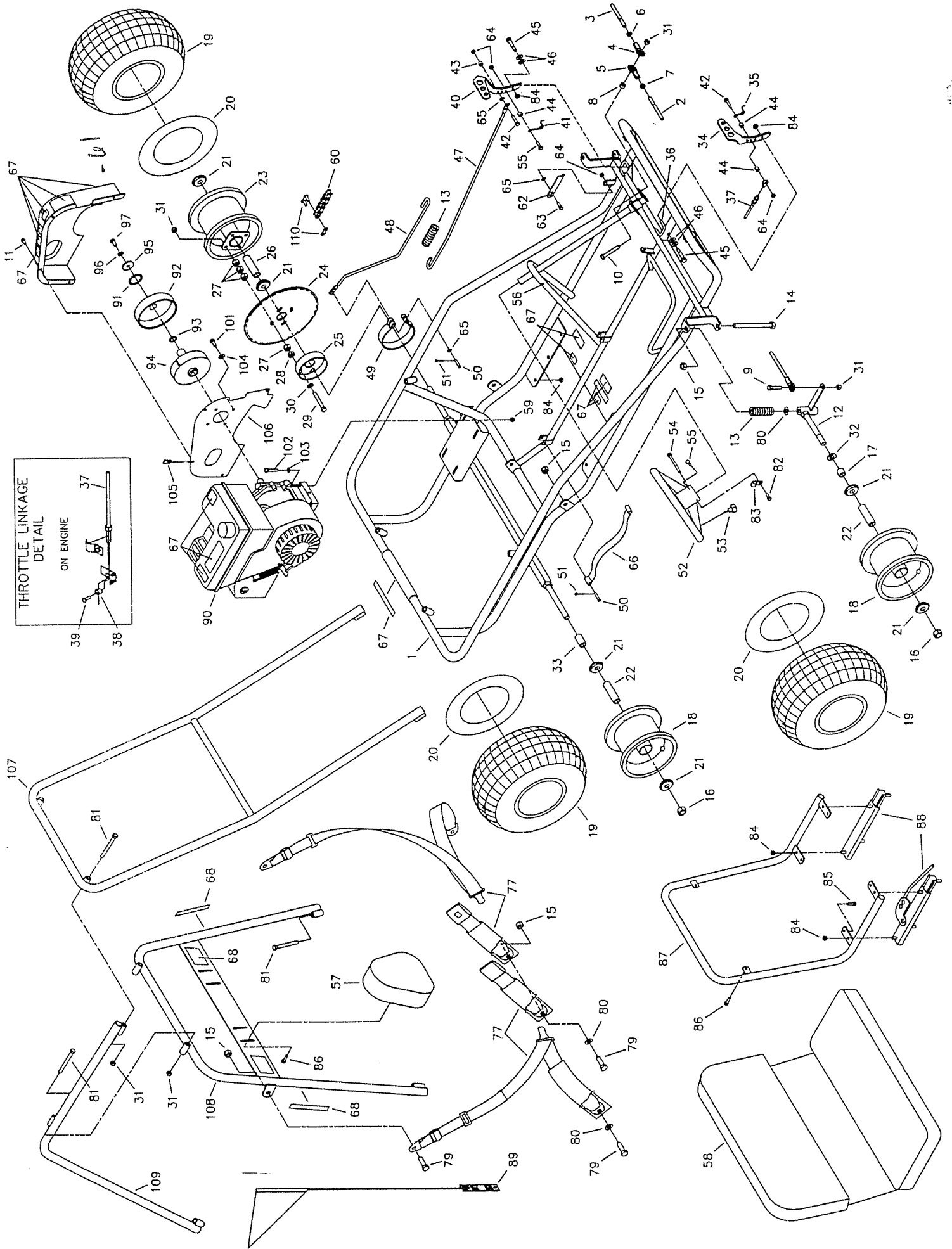

REPAIR PARTS - MODELS 415B, 415D 416B, 416D, 416K

11382-29
416B-17

REF NO.	PART NO.	DESCRIPTION	REF NO.	PART NO.	DESCRIPTION
1	10525-5	FRAME WELDMENT, RED	90	9661C	ENGINE 5HP TEC OHV (415B, 415D)
ASM	10869	TIE ROD ASM LONG (INCL. 2, 4-7)	5533		ENGINE 6HP TEC OHV (416B, 416D)
ASM	5020	TIE ROD ASM SHORT (INCL. 3-7)	10295		ENGINE 6HP TEC OHV W/ COIL (416K)
2	10868	TIE ROD 19.0	4335	ASM	CLUTCH .75ID 35 X 12 TEETH (INCL. 91-94)
3	5004	TIE ROD 7.25	91	3141	RETAINING RING
4	1415	TIE ROD END LH THREAD	92	4491	DRUM/SPROCKET/BUSHING ASSEMBLY
5	1414	TIE ROD END RH THREAD	93	3146	FIBER WASHER
6	9024	NUT, 3/8-24 JAM LH THREAD	94	4496	CLUTCH ROTOR (WEIGHT ASSEMBLY)
7	9092	NUT, 3/8-24 JAM RH THREAD	95	1398	WASHER, 21/64 ID X 1 1/4 X 1/8
8	9674-16	SPACER, 3/8 ID X 3/8 LONG	96	1124	WASHER, 5/16 SPLIT LOCK
9	9146	BOLT, 3/8-16 X 1.50	97	1491	BOLT, 5/16-24 X .750
10	9158	BOLT, 3/8-16 X 2.25	98	5964	DECAL, SHIPPED W/O OIL
11	9006	BOLT, 1/4-20 X .50 HEX FLANGED WHIZ	99	9677	DECAL, WARNING HOT SURFACES
NI	10548-2Z	SPINDLE WELDMENT LEFT BLACK	100	9678	DECAL, ENGINE EXHAUST
12	10549-2Z	SPINDLE WELDMENT RIGHT BLACK	101	9101	BOLT, 5/16-24 X .500 W/ NYLON
13	9709	COMPRESSION SPRING	102	9186	BOLT, 5/16-18 X 1.500
14	5682	BOLT, 1/2-13 X 5.500	103	9030	WASHER, 5/16 INT/EXT LOCK
15	1012	NUT, 1/2-13 TOPLOCK	104	9060	WASHER, 5/16 FLAT
16	1046	NUT, 5/8-11 TOPLOCK	105	8227	NUT, 1/4-20 TINNERMAN
17	1104	SPACER SPLIT .812OD .625ID 1.000L	106	10749-2	PLATE, COVER 415 BLACK
18	9309FP	WHEEL ASSEMBLY, IDLE (INCL. 19-22)	107	10537-2	OVERHEAD BAR WELDMENT BLACK
ASM	10769	WHEEL ASSEMBLY, DRIVE (INCL. 20-21, 23-31)	108	10544-2	CENTER BAR WELDMENT BLACK
19	4915	TIRE 145/70 X 6" KNOBBY	109	10541-2	REAR BAR WELDMENT BLACK
20	3802	INNER TUBE 6"	110	1269	MASTERLINK 35 CHAIN
21	5090	BEARING, 5/8" I.D.	NI	11344	RUNNING LIGHT KIT (416K ONLY)
22	5950	SPANNER, 5/8" I.D. X 2-1/8"	NI	4350	OPERATOR'S MANUAL
23	8499B	TIRE & DRIVE WHEEL ASSEMBLY 145/70 X 6"			
24	9986	SPROCKET 35P X 80 TEETH			
25	1246	BRAKE DRUM, 4"			
26	8598	SPANNER, 5/8 I.D. X 3.641			
27	8409	NUT, 1/2-20 HEX			
28	9169	NUT, 1/2-20 HEX JAM			
29	9190	BOLT, 3/8-16 X 3-1/4			
30	9091	WASHER, FLAT 3/8 SAE N			
31	9085	NUT, 3/8-16 TOPLOCK HEX			
32	1119	SPACER .625ID 1.062OD .125THK Z			
33	2024-16	SPACER .875OD .625ID 1.500L Z			
34	6309-16	PEDAL, THROTTLE TRIMMED			
35	9503	SPRING, PEDAL RIGHT WOUND			
36	9929	RUBBER CAP .25ID X .25 BLACK			
37	8252	THROTTLE CABLE 61 INCH			
38	2748	CABLE STOP NUT			
39	2666	SWIVEL SCREW			
40	6293-16	PEDAL, BRAKE TRIMMED			
41	9502	SPRING, PEDAL LEFT WOUND			
42	1848	BOLT, 1/4-20 X 1.25			
43	6349	BUSHING, 5/16 OD X 22G			
44	1389	BUSHING, 1/4 ID X .313			
45	1447	BOLT, 3/8 X 1-1/8 SHOULDER			
46	9091	WASHER, FLAT 3/8 SAE N			
47	9945-2	BRAKE ROD - FRONT BLACK			
48	9946-2	BRAKE ROD - REAR BLACK			
49	1036	BRAKE BAND W/RETAINER			
50	9118	PIN, CLEVIS 1/4 X 1.250 Z			
51	9116	PIN, COTTER 3/32 X .750 Z			
52	6038	STEERING WHEEL			
53	9799	STOP SWITCH WIRE ASM			
NI	1406	STOP SWITCH WIRE EXTENSION			
54	9080	BOLT, 1/4-20 X 2.750			
55	9160	BOLT, 1/4-20 X .875			
56	9796	BOLT, #12-24 X .500 SELF TAPPING			
57	6320	HEADREST PLAIN			
58	8370	SEAT BACK/BOTTOM			
59	1263	NUT 5/16-18 HEX FLANGED WHIZ			
60	9978	CHAIN, 35 X 86P (INCL. 110)			
61	10750	COVER, 415 W&W/O SR			
62	1982-2	PEDAL LATCH, BLACK			
63	1846	BOLT, 1/4-20 X .750			
64	9057	NUT, 1/4-20 TOPLOCK			
65	1854	WASHER, #14 FLAT MS Z			
66	4372	HANDHOLD STRAP			
67	10330	DECAL SHEET, MAIN FRAME AND ENGINE WARNINGS			
68	10329	DECAL SHEET, CENTER BAR WARNINGS			
69	-----	-----			
70	-----	-----			
71	-----	-----			
72	-----	-----			
73	-----	-----			
74	-----	-----			
75	-----	-----			
76	-----	-----			
77	8373	SEAT BELT - SHOULDER/LAP			
78	-----	-----			
79	9188	BOLT, 1/2-13 X 1.50			
80	9022	WASHER, 1/2 FLAT			
81	2386	BOLT, 3/8-16 X 3.50			
NI	8746M	VIDEO TAPE SAFETY MANCO			
82	5287	BOLT #10-16 X .375 SELF TAPPING			
83	5288	WIRE CLAMP			
84	1189	NUT, 5/16-18 HEX TOPLOCK			
85	9189	BOLT, 1/4-20 X .875 HEX FLANGED WHIZ			
86	1876	BOLT 1/4-20 X .625 HEX FLANGED WHIZ			
87	9968-2	SEAT FRAME WELDMENT BLACK			
88	6734	SEAT SLIDE PR - SHORT			
89	8445	FLAG SAFETY W/ BRKT 3FT			

ASM = ASSEMBLY
NI = NOT ILLUSTRATED